

PolySto OP30F SaniCoat

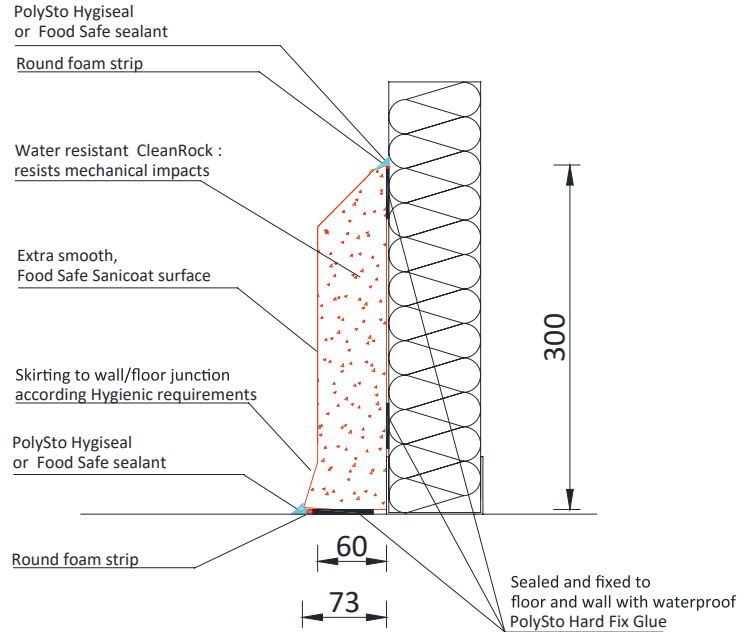

Protection level 3
Impact protection against
manual pallets

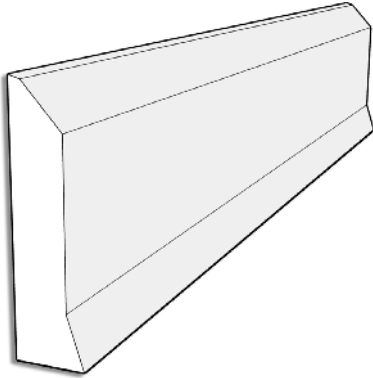

Specification

PolySto OP30F SaniCoat is a prefabricated full core kerb 1500x60x300mmH with sloped top and skirting to wall-floor according hygienic requirements. The OP30F SaniCoat kerb consists of a water repellent durable CleanRock mass and the surface is finished Food Safe with a smooth SaniCoat (Polyester gelcoat). Including matching accessories; prefabricated internal and external corners and endpieces.

Waterproof bonding using PolySto Hard Fix Glue (Hybrid Polymere). Finishing of the joints using PolySto Food Safe Sealant or a chemical welding HygiSeal.

Consumption

Consumption Food Safe sealant (per meter)

Food Safe sealant white	200 cc
Food Safe sealant transparent	150 cc
Hard Fix Glue	450 cc
Installation m/day (8h) with 2 installers	60 meter

Consumption HygiSeal (per meter)

HygiSeal white	150 cc
Hard Fix Glue	450 cc
Installation m/day (8h) with 2 installers	40 meter

Technical info

	Kerb	Corner internal / external	End piece right / left
Length	1.500 mm	2 x 500 mm	500 mm
Height	300 mm	300 mm	300 mm
Thickness	60 mm	60 mm	60 mm
Weight	57,80 kg	38,50 kg	19,25 kg
Amount / pallet	30 m	20 pc	20 R & 20 L
Pallet size	155x65x70cmH	120x80x70cmH	120x80x70cmH
Pallet weight	+/- 1.170 kg	+/- 790 kg	+/- 790 kg

Kerb

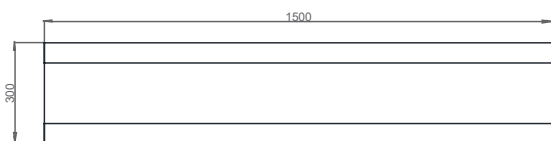

Internal corner

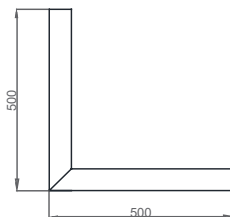

External corner

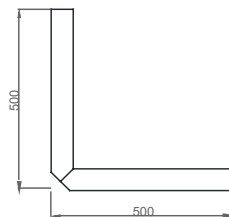

End piece

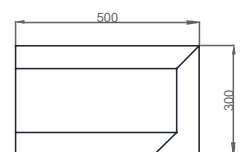

POLYSTO BVBA

CONTACT

Maesbossen 3
9160 Lokeren
Belgium

T. +32 9 33 77 660
E. info@polysto.com
www.polysto.com

Soon available for **BIM** (Building information modeling)