

HERMETIC OIL SEPARATORS / SEPARADORES DE ACEITE HERMÉTICOS

30 bar -10/80°C			Kg	Vt (L)	Va (L)	Dimensions Dimensiones (mm)				Oil back hole	Capacity Kw at Evap. Temp.°C Capacidad Kw a Temp. Evap. °C					
CAT.	SH	Ø				H	L	E	R-134a		R-404A/507		R-407			
									-40°C		5°C	-40°C	5°C	-40°C	5°C	
CAT.I	SH1 (1/2")	76,001	2.9	2	0.7	102	290	255	52	1/4" SAE	3,9	4,7	5,6	7,2	5,7	6,9
CAT.I	SH2 (5/8)	76,002	3.6	2.7	0.7		385	350			10,9	13,2	15,4	19,8	15,6	18,8
CAT.I	SH3 (7/8")	76,003	4.3	3.5	0.7		490	455			16,3	19,9	23	29,7	23,4	27,9
CAT.I	SH4 (1 1/8")	76,004	4.6	4	0.7	114	525	485	60	3/8" SAE	21,2	26	30,2	39	31	37
CAT.I	SH5 (1 3/8")	76,005	5.2	5	0.87		535	485			25,1	33,2	38,6	49,9	40,2	46,7
CAT.II	SH6 (1 5/8")	76,006	6.4	7.5	1.54		480	430			37,7	46	53,4	68,9	54,5	65,1
CAT.II	SH7 (2 1/8")	76,007	7.4	8.5	1.54	152	545	490	80		60,4	73,9	85,8	110,3	87,6	104,3

VALID FOR ALL THE REFRIGERANTS HFC: R22, R134a, R404A, R507,ETC

VÁLIDO PARA TODOS LOS REFRIGERANTES HFC: R22, R134a, R404A, R507,ETC

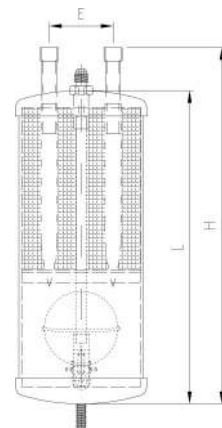

HERMETIC OIL SEPARATORS FOR R410A / SEPARADORES DE ACEITE HERMÉTICOS PARA R410A

30 bar -10/120°C 45bar -10/80°C			Kg	Vt (L)	Va (L)	Dimensions				Oil back hole Connexion Huile	
CAT.	SH	D				A	B	C	Oil back hole		
									1/4"		3/8"
CAT.I	SH1 (1/2")-45	76,008	2.9	2	0.7	102	290	255	52	1/4"	
CAT.I	SH2 (5/8)-45	76,009	3.6	2.7	0.7		385	350		3/8"	
CAT.I	SH3 (7/8")-45	76,010	4.3	3.5	0.7		493	455		3/8"	
CAT.I	SH4 (1 1/8")-45	76,011	4.6	4	0.7	114	525	485	60	3/8"	
CAT.I	SH5 (1 3/8")-45	76,012	5.2	5	0.87		535	485			
CAT.II	SH6 (1 5/8")-45	76,013	6.4	7.5	1.54		480	430			80
CAT.II	SH7 (2 1/8")-45	76,014	7.4	8.5	1.54	152	545	490	80	3/8"	

CO₂



SECTIONAL OIL SEPARATORS / SEPARADORES DE ACEITE DESMONTABLES

30 bar -10/80°C			Kg	Vt (L)	Va (L)	Dimensions Dimensiones (mm)				Oil back	Capacity Kw at Evap. Temp.°C Capacidad Kw a Temp. Evap. °C					
CAT.	SD	Ø				H	L	E	R-134a		R-404A/507		R-407			
									-40°C		5°C	-40°C	5°C	-40°C	5°C	
CAT.I	SD1 (1/2")	77,001	3.5	2	0.7	102	290	255	48	1/4" SAE	3,9	4,7	5,6	7,2	5,7	6,9
CAT.I	SD2 (5/8)	77,002	4.2	2.7	0.7		385	350			10,9	13,2	15,4	19,8	15,6	18,8
CAT.I	SD3 (7/8")	77,003	4.8	3.5	0.7		490	455			16,3	19,9	23	29,7	23,4	27,9
CAT.I	SD4 (1 1/8")	77,004	5.2	4	0.7	114	525	485	57	3/8" SAE	21,2	26	30,2	39	31	37
CAT.I	SD5 (1 3/8")	77,005	6.1	5	0.87		535	485			25,1	33,2	38,6	49,9	40,2	46,7
CAT.II	SD6 (1 5/8")	77,006	8.3	7.5	1.54		480	430			37,7	46	53,4	68,9	54,5	65,1
CAT.II	SD7 (2 1/8")	77,007	9	8.5	1.54	152	545	490	75		60,4	73,9	85,8	110,3	87,6	104,3

VALID FOR ALL THE REFRIGERANTS HFC: R22, R134a, R404A, R507,ETC

VÁLIDO PARA TODOS LOS REFRIGERANTES HFC: R22, R134a, R404A, R507,ETC

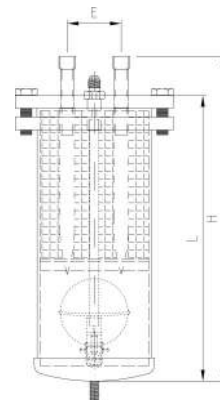

SECTIONAL OIL SEPARATORS FOR R410A / SEPARADORES DE ACEITE DESMONTABLES PARA R410A

30 bar -10/120°C 45bar -10/80°C			Kg	Vt (L)	Dimensions (mm)				Oil back hole Connexion Huile	
CAT.	SD	D			A	B	C	Oil back hole		
								1/4"		3/8"
CAT.I	SD1 (1/2")-45	77,008	3.5	2	102	290	255	48	1/4"	
CAT.I	SD2 (5/8)-45	77,009	4.2	2.7		385	350		3/8"	
CAT.I	SD3 (7/8")-45	77,010	4.8	3.5		493	455		3/8"	
CAT.I	SD4 (1 1/8")-45	77,011	5.2	4	114	525	485	57	3/8"	
CAT.I	SD5 (1 3/8")-45	77,012	6.1	5		535	485			
CAT.II	SD6 (1 5/8")-45	77,013	8.3	7.5		480	430			75
CAT.II	SD7 (2 1/8")-45	77,014	9	8.5	152	545	490	75	3/8"	

CO₂



ALL THE MODELS ARE PAINTED IN BLACK

TODOS LOS MODELOS SON PINTADOS EN NEGRO

